

WTS LA EXPRESS

MARCH 2014

Advancing Women in Transportation
Los Angeles Area Chapter



BOARD OF DIRECTORS

President
Lynda Bybee

Vice President (Membership)
Paula Hernandez
LTK Engineering Services

Treasurer
Jill Liu
Fehr & Peers

Secretary
Jenelle Saunders
Berg & Associates Construction
Management

Immediate Past President
Melissa de la Peña, P.E.
CH2M Hill

DIRECTORS AT LARGE

Dina Aryan-Zahlan, P.E., PMP
Port of Los Angeles

Michelle Boehm
California High-Speed Rail
Authority

Carrie Bowen
Caltrans District 7

Samantha Bricker
Exposition Construction
Authority

Doug Failing, P.E.

Cynthia Guidry, P.E.
Los Angeles World Airports

Gary Lee Moore, P.E.
City of Los Angeles

Professor James E. Moore II
University of Southern California

Eric Shen, P.E., PTP
Port of Long Beach

Martha Welborne, FAIA
Metro

CORPORATE SPONSORS

PLATINUM
AECOM
Arcadis
CH2M Hill, Inc.
HDR
Parsons Brinckerhoff, Inc.
Stantec
URS

GOLD
Berg & Associates
Hatch Mott MacDonald
Jacobs
John Livzey Photography
Nossaman, LLP
Overland Pacific & Cutler, Inc.
Port of Long Beach
Port of Los Angeles

SILVER
HNTB
JL Patterson
Lea+Elliot, Inc.
Loudmouth Graphics

MESSAGE FROM THE PRESIDENT

Fixing Ground Transportation: A Rail Active Approach



exclusive program, click [here](#). We look forward to seeing you there.

Lynda Bybee

On Monday, WTS-LA will reveal to its members how airport transportation will change forever in the City of Angels as we welcome Los Angeles City Councilmember and City Council Transportation Committee Chair Mike Bonin to discuss in depth his proposal for a new ground transportation center that will connect LAX with Metro's Green Line and Crenshaw Line. He'll also talk about the approaching historic moment where the Expo Light Rail line will once again connect the Westside to the rest of Los Angeles by rail. To learn more about this

IN THE NEWS

Road's Scholar Shows New Way to Complete Streets



Streets are more than just concrete or macadam. No one understands this better than Madeline Brozen, a WTS-LA member, two-time WTS-LA scholarship winner, and program director of the UCLA Complete Streets initiative.

What is Complete Streets all about? "Complete Streets is a policy and design approach wherein streets are planned, designed, and maintained to maximize safety, convenience, comfortable travel, and holistic

access for all types of users and all types of modes."

Supported by UCLA's Lewis Center for Regional Policy Studies, Luskin Center for Innovation, and the dean's office of the Luskin School for Public Affairs, Brozen's Complete Streets provides decision support tools to policy makers, researchers, and educators.

Amanda Smith Takes Membership Drive for the Win



Increasing membership is no mean feat. But transportation planner and WTS-LA programs co-chair Amanda Smith did the legwork to help increase WTS membership by an order of magnitude.

Winning first place in WTS International's 2013 Member-Get-a-Member Referral Contest, Smith recruited more new WTS members than any other participant. In doing so she won the grand prize of a paid 2014 Annual Conference Registration, valued at \$700.

Excited about increasing the size of WTS Los Angeles, Smith is equally eager to attend this year's annual conference. Increasing membership is no mean feat. But Amanda Smith has legged out a win by bringing in more new members than anyone else.

COMMITTEE REPORTS

For Graduating Students, A Book Where the Titles Are Yet to Come



This book is truly the best seller. Celebrating almost a decade of publication, the 2014 WTS-LA Transportation Résumé Book does double duty by providing WTS-LA corporate partners with an exclusive first look at bright, young transportation professionals.

But it also affords those young professionals with a direct link to transportation organizations looking for top talent. Newly appointed TRB Committee chair Lucy Terrell explains, though, that there will be a significant change this year, "We're switching

from a CD format to an online format, but it will still be the same vital, invaluable resource."

Résumés are due March 21. For complete information, click [here](#). To participate in the TRB, contact Lucy at wtsLAResumeBook@gmail.com.

LTK Engineering
Metro
Rail Pros, Inc.
STV, Inc.
Twining, Inc.
USC

BRONZE
Anil Verma Associates, Inc.
DCA Civil Engineering Group
Diaz Yourman
Earth Mechanics, Inc. (EMI)
Katherine Padilla & Associates
Lee Andrews Group
Morgner
Technology Management
Paragon Partners
Spencer Schurr

WTS-LA Has NO Volunteers; We Have Investors



There is no greater gift than time. Though WTS-LA boasts a number of people who donate their time to the chapter, we need more. But those select individuals who do volunteer know this: WTS-LA volunteers gain much, much more than they give when they work for the chapter.

No one knows this better than ICF International senior proposal manager and WTS-LA Volunteer Committee chair Jeff Markwardt. And he's got a plan. "Through our volunteer opportunities, we're looking to develop leadership skills, foster mentor-protégée relationships, position members for career advancement, and provide eyeball-to-eyeball access to an international group of transportation leaders. And that's just the short list!"

There is no greater gift than time. But volunteering your time to WTS-LA is no gift. It's an investment. To better your career through volunteering, contact Jeff at Jeff.Markwardt@icfi.com.

MEMBER PROFILE

Anil Verma: A Renaissance Man by Design



Leonardo Da Vinci said, "Life is pretty simple: You do some stuff. Most fails. Some works. You do more of what works. If it works big, others quickly copy it. Then you do something else. The trick is the doing something else." No one better captures Da Vinci's courage and penchant for exploration than Anil Verma.

"Though I'm an architect-urban designer by profession, I have spent most of my career working on rail transportation projects.

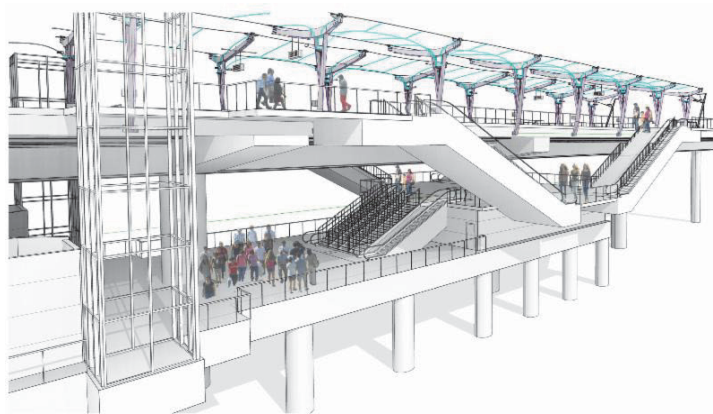

"I came to North America (Vancouver B.C., Canada) more than 40 years ago to work for the United Nations on an international conference on human settlements called the

Habitat Forum. Later I went to Tehran on a two-year assignment with a British company to work on the design of three new towns and the planning of five cities around the Caspian Sea. I came back to the US to pursue a PhD at Harvard, but I dropped out and settled for Master's. I have two master's degrees (one in architecture/urban design and the other in landscape architecture/business).

"While in Cambridge I went to the Harvard business school, law school, and studied forestry. I even studied film making at MIT under a very famous film maker. Oddly enough, all of these subjects have proven to be very useful throughout my career."

That's only the short list of Verma's derring-do. And he carries his sense of exploration on every endeavor, including the company he founded. To read more about this fascinating WTS Los Angeles member, click [here](#).

Photographs by [John Livzey](#); depiction of Honolulu Rail Transit's Pearl Highlands Station courtesy of [Anil Verma Associates](#).

WTS LOS ANGELES AREA CHAPTER

wtslosangeles@gmail.com
www.wtsinternational.org/losangeles
www.twitter.com/wtslosangeles

Copyright © 2013. All Rights Reserved.

AlexandraSpencer@aol.com



Try it FREE today.

This email was sent to by wtslosangeles@gmail.com |
[Update Profile/Email Address](#) | Instant removal with [SafeUnsubscribe™](#) | [Privacy Policy](#).

WTS Los Angeles | P.O. Box 71504 | Los Angeles | CA | 90071-0504